

Hi-Tech Blowers, Inc. forward curved Centrifugal Blower Wheels.

Strip Wheel - Single & Double Inlet

Materials: Galvanized steel, aluminum, aluminized steel, stainless steel.

Standard hub bore sizes: 1/4", 5/16", 3/8", 1/2", 5/8", 3/4", others per request.

One set screw - standard. More screws, key-way, pulling groove - special order.

CENTRIFUGAL STRIP WHEELS
Single Inlet

D DIAMETER (Inches)

A Width (Inches)

N9.45	N8.45	N7.87	N7.28	N6.31	NB5.75	N5.75	NB5.25	N5.25	NB4.75	N4.75	N4.25	N3.81	N3.19	N3.00	A Width (Inches)
															1.03
															1.50
															1.87
															2.00
															2.50
															2.93
															3.25
															3.43
															3.81
															4.00
															4.33
															4.62
															4.72
8.74	7.71	7.09	6.51	5.63	5.20	5.20	4.70	4.70	4.21	4.21	3.75	3.25	2.67	2.50	Inside Ring d
					1.45		0.90		0.79						H

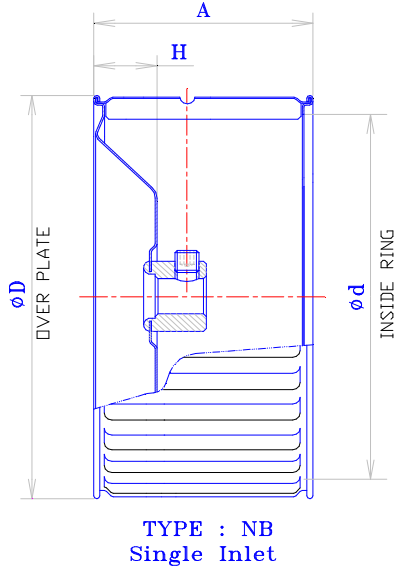
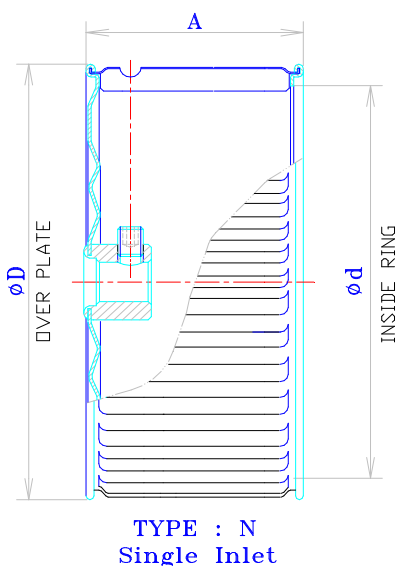

CENTRIFUGAL STRIP WHEELS
Double Inlet

D DIAMETER (Inches)												W Width (Inches)
N9.45	N8.45	N7.87	N7.28	N6.31	N5.75	N5.25	N4.75	N4.25	N3.81	N3.19	N3	
												2.06
												3.00
												3.75
												4.00
												5.00
												5.75
												6.50
												7.00
												7.62
												7.87
												8.66
												9.25
												9.45
8.74	7.71	7.09	6.51	5.63	5.2	4.70	4.21	3.75	3.25	2.67	2.50	Inside Ring d

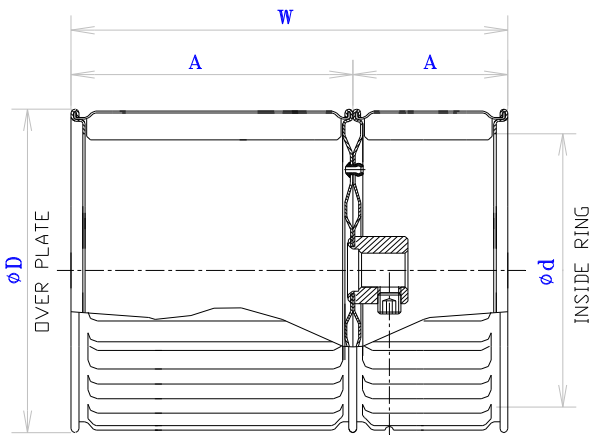

TYPE : N
Double Inlet

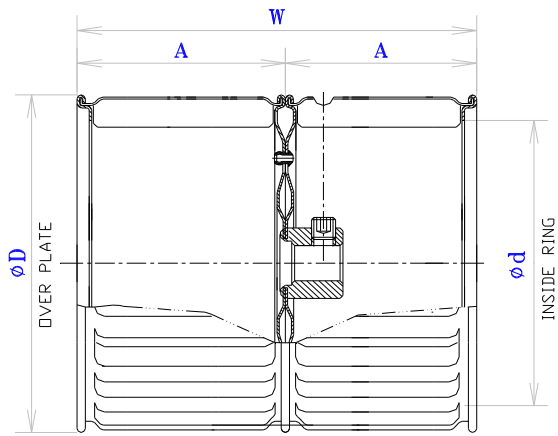

TYPE : N
Double Inlet



**CENTRIFUGAL STRIP WHEELS "SPIDER TYPE"
Single Inlet**

D DIAMETER (Inches)		A Width (Inches)
N Spider 787	N Spider 600	
		2.00
		2.50
		2.93
		3.25
		3.43
		3.81
		4.00
		4.33
		4.62
		4.72
7.09	5.31	Inside Ring d
1.63	1.02	H

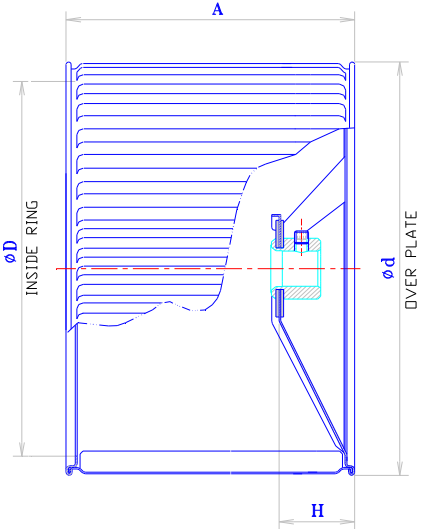

CENTRIFUGAL STRIP WHEELS " NH TYPE "
Single Inlet

D DIAMETER (Inches)	A Width (Inches)
NH 525	
	1.03
	1.50
	1.87
	2.00
	2.50
	2.93
	3.25
	3.43
	3.81
	4.00
	4.33
	4.62
	4.72
4.73	Inside Ring d

